

TECE
close to you

Design & Creation

**FREEDOM IN
DESIGN**

CLOSE TO YOU.

Understanding people and their requirements – that is what motivates us.

In this spirit, and with our customers in mind, we develop products and services that offer more room for creativity and convenience in terms of use.

A WORLD OF SOLUTIONS.

TECE is an innovator in the sanitary installation sector. We make an impact with products that can be used to build an entire world. With well-thought-out solutions, reliable technology, long-lasting functions and timeless design.

Get to know us

We are a medium-sized, family-owned and run business with headquarters in Emsdetten (Germany). We have been developing products and services for fitters, planners and architects ever since the company was established in 1987. Today, with 22 international branches, we feel at home all over the world and maintain open communication with our partners in the full spirit of "Close to you".



Wall sections and pre-wall installations

Bathroom wall sections and system shafts for construction projects



Pipe systems

Push sleeve systems, push-fit systems and floor heating systems



Floor heating system

Complete system of heating pipes, installation accessories, manifolds and controls



Flush plates

Selected collections for private homes or public buildings, with different designs, materials and colours



Sanitary systems

From toilet ceramics and flush plates to sanitary modules



Drainage systems

Shower channels, shower profiles and point drainage systems



Grease separators

Plastic grease separators for free-standing or underground installation, mobile stainless steel grease separators and lifting systems



“What reflects an architect’s wishes more – designing monotonous wet rooms or creating modern bathrooms?”



“How should product technology be designed so that it does not restrict, but actually supports, customised bathroom planning?”



“In architecture, does top design and efficiency have to be a contradiction in terms?”

MORE ROOM FOR IDEAS.

Architecture evolves in line with social changes. Functional and aesthetic demands are increasing in all living spaces, including in the bathroom. Whether private or public. That is why freedom in design is more important than ever before.

“Nowadays, bathrooms are as individual as the people that use them. Therefore, maximum freedom in design must be given top priority if the perfect layout is to be achieved.”



Optimum use of space

The bathroom is increasingly becoming the heart of the home. Architects are facing new challenges in this respect. Good planning and freedom in design are important aspects – regardless of the size of the room or budget. An intelligent and modern bathroom layout helps to turn what is actually a functional space into an attractive comfort zone.

Individuality requires good design

Good design comes with a timeless and high-quality style. In conjunction with a high variety of surfaces and materials, it gives architects and planners the freedom to customise different living spaces.

Freedom with systems

Bathroom planning can be easy. The prerequisite for this is a perfectly harmonised system in terms of design and technology. Every type of project, whether for the private or public domain, can be planned and implemented easily and efficiently.



CONTENTS

- 06 **Space & Architecture**
Re-thinking the bathroom.
- 16 **Individuality & Design**
Designs with personality.
- 26 **Function & Innovation**
Safety in the system.
- 32 **Services & Academy**
Run by professionals for professionals.

FREEDOM IN DESIGN

SPACE & ARCHITECTURE

Re-thinking the bathroom.



THINKING CREATIVELY IN TERMS OF SPACE.



1

Thinking holistically for complete solutions

Convincing architecture is consistent from the overall design right down to the smallest detail. In the bathroom and sanitary areas, TECE supports this approach with its consistent product philosophy: modular, compatible, full of variance in terms of surfaces and materials.

Ideas are expressed freely both outside and inside.

- 1 Over a million bathrooms have already been designed using the TECEdrainline shower channel.
- 2 The TECEdrainline shower channel "plate" is designed in such a way that the floor cover – tiles or natural stone – continues even over the channel. Only a surrounding narrow gap remains visible. Stripped down to the essentials.



2

TECEdrainline shower channels form the interface between architecture and housing technology: They strip function and design right down to the essentials, freeing the bathroom from its limitations. The result: a uniform, limitation-free floor and space design – for real living spaces.

BATHROOMS WITHOUT BARRIERS.

Totally new bathroom layouts can be designed thanks to our pre-wall systems. The use of pre-wall elements allows for customised interior design as they mean that predetermined installations or housing technology no longer have to be strictly followed. The layout of main usage areas such as the wash area, toilet, bath or shower can be completely rethought and re-structured.

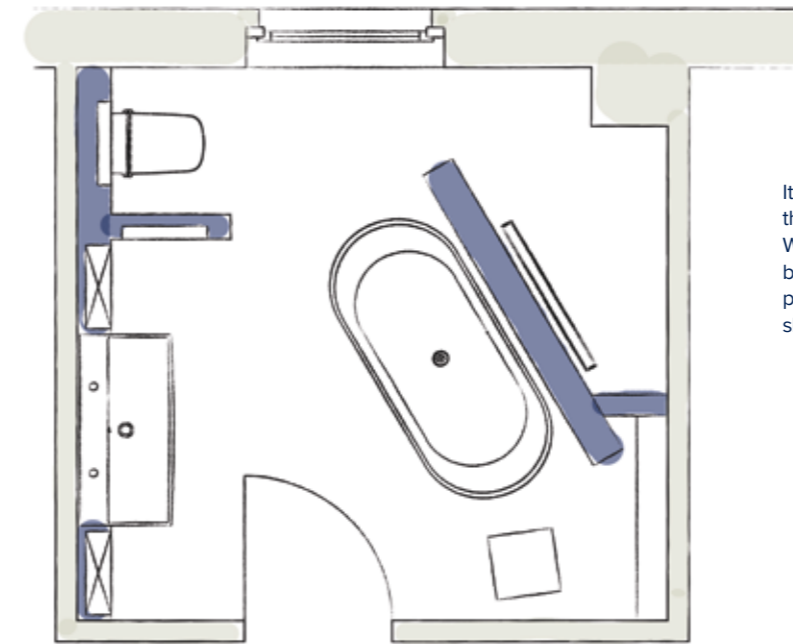

It does not always have to be set along the wall: the bath takes up a lot of space in the bathroom. With the aid of a pre-wall system, positioning the bath in the centre of the room no longer poses a problem and leaves plenty of room for a floor-level shower too.

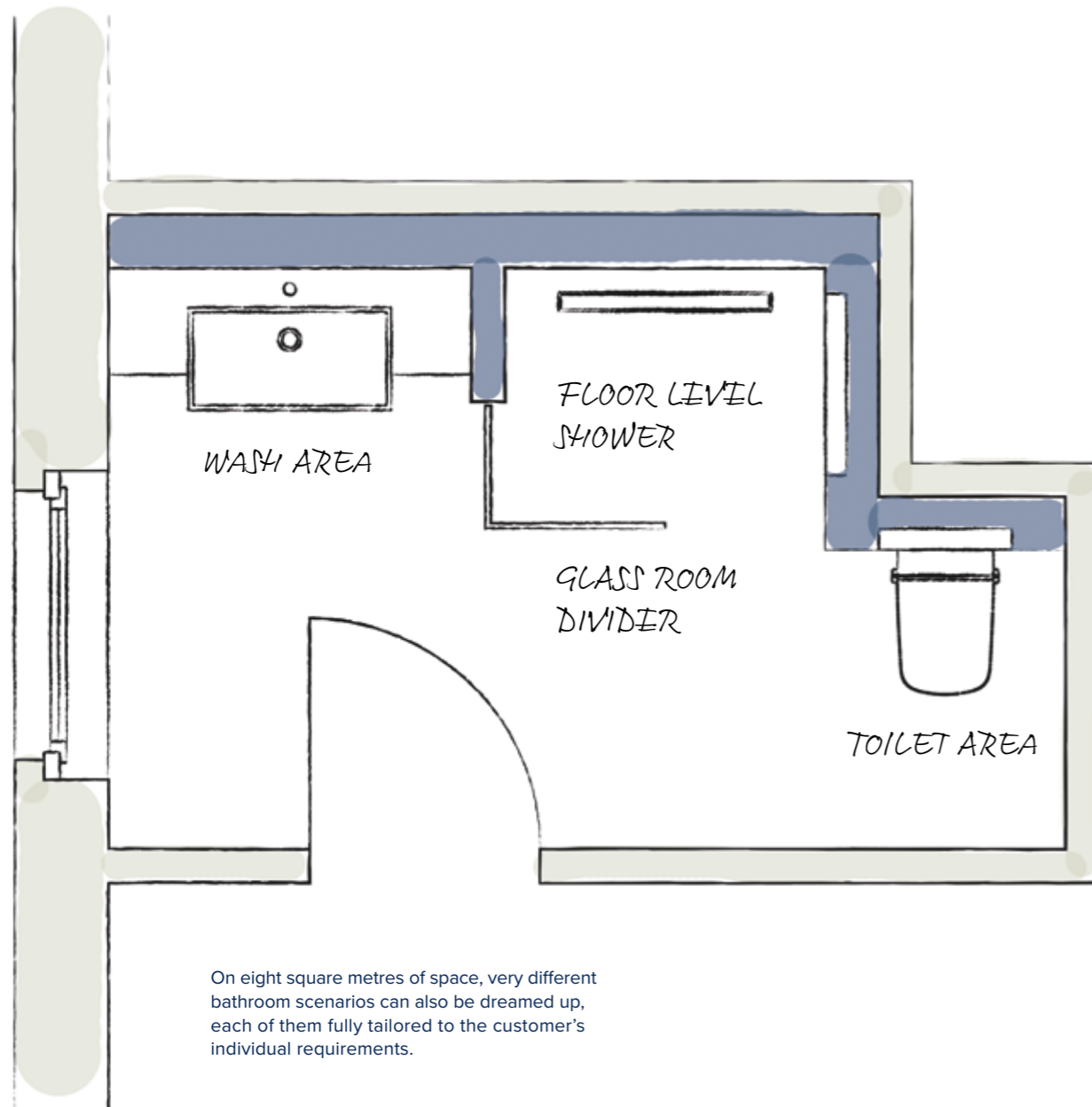

On eight square metres of space, very different bathroom scenarios can also be dreamed up, each of them fully tailored to the customer's individual requirements.

Customised possibilities

New builds or renovations: Through the interaction of wall sections, sanitary systems and shower channels, smaller rooms can also be supplied with all the mod cons and be made to look larger.

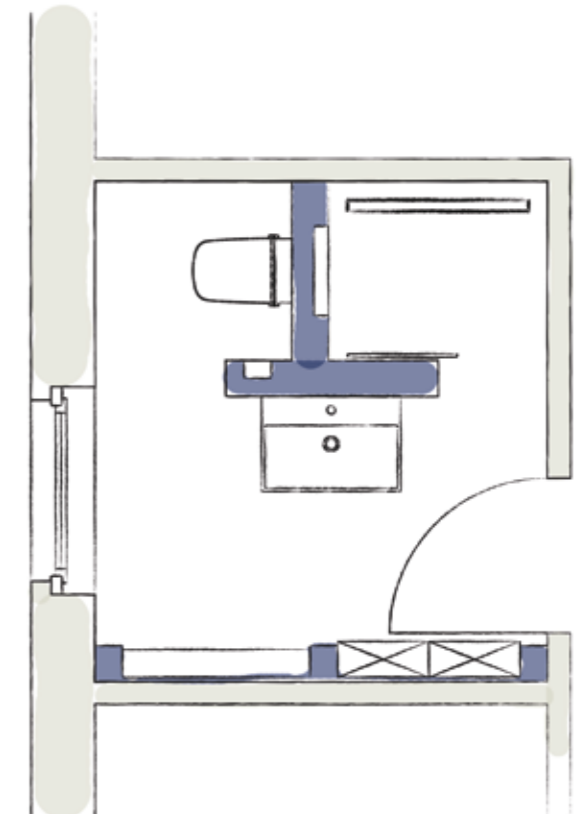

Accessible bathrooms can also be tailor-made. The wash area becomes an element that divides the room, set against a centrally-located pre-wall element. The toilet area is no longer directly visible, and the floor-level shower is visually unobtrusive while enabling maximum freedom of movement.

SO SIMPLE AND SO DIVERSE.

TECE pre-wall systems are designed according to a modular principle. Thanks to their modular construction, a wide range of combinations and therefore great diversity can be achieved in the bathroom.

1 TECE pre-wall systems have a modular design and offer maximum freedom when planning a customised and efficient layout.



1



2

2 The TECEprofil pre-wall system includes supporting structures and sanitary modules for all functional areas in the bathroom. From the washbasin and urinals to toilet modules.

3 Odour extraction, connection for shower toilets or support arms – TECEprofil offers many possibilities.

1 TECE pre-wall systems have a modular design, offering maximum safety for a customised and efficient layout.
2 The system contains modules for easy integration of other bathroom elements such as sanitary ware, taps or furnishings.

THE PATH TO THE BATH.

From the first sketches to the finished bathroom, the process should be as easy as possible. A well-thought-out product system facilitates each step when planning the bathroom.



“Today, the requirements for modern bathrooms are much more demanding than just a few years ago. An unobstructed interior design and efficient planning of all the details are extremely important.”

Joerg Verwolth, Architect and member of the BDA (German Architect's Association)

The contemporary bathroom

Contemporary bathroom design does not mean building extraordinary bathrooms. It is far more important to plan and design a room with the long term in mind. The bathroom must be able to adapt to every life situation – freedom from limitations is the keyword here – you never know when you may want to modernise certain elements without having to rip everything off the wall. The size of the bathroom is not important. Above all, everything depends on ensuring efficient use of space.

Simple and efficient designs

The process is assisted by sophisticated products and planning systems which are actually designed to use space intelligently. The shower area provides a good example of a room which can be further developed. Demarcated wet areas can be designed with free-standing pre-wall systems, shower channels enable a continuous and generous space; and easy access also facilitates practical cleaning. In the home, a rented flat or a hotel en-suite bathroom.

Finally, a good bathroom design also clearly depends on the choice of colours and materials – i.e. that extra little something that enhances individuality. In each case, more than ever before, the bathroom is an expression of personality, and increasing requirements demand well-thought-out solutions.

Bathrooms in the housing sector

A universal bathroom design not only offers convenience for tenants but also increases the property's overall value. People from all generations feel at home in this type of bathroom.



2



1

A bathroom for all generations

Accessible layouts offer universal value. The associated level of comfort is not a question of age or disability. In the bathroom, easy access for every user offers a pleasant experience for children, adults and senior citizens alike.

1 TECE display bathroom for the housing sector
2 TECE display bathroom demonstrating accessibility

FREEDOM IN DESIGN

INDIVIDUALITY & DESIGN

Designs with personality.

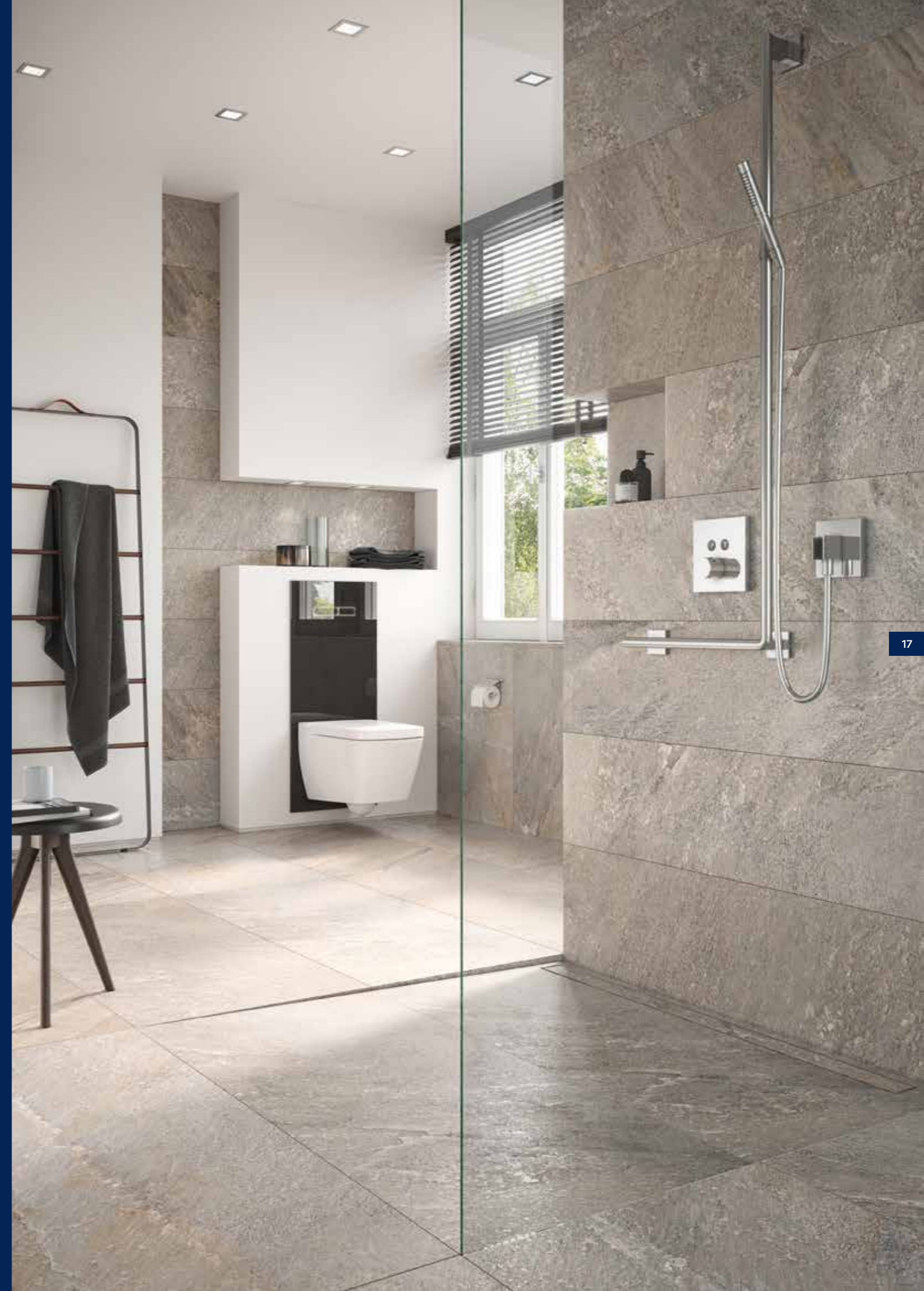

A BATHROOM IS A PERSONAL THING.

The floor space may well be predetermined, but this is not the case for the bathroom's design. TECE products are aimed at enabling fully customised concepts to be created while sticking to the specified budget.



A family bathroom suitable for everyday life

In homes with children, in addition to convenience and safety, easy operation is another important aspect. For this type of project with average budgets, TECE has a wide range of solutions at the ready.

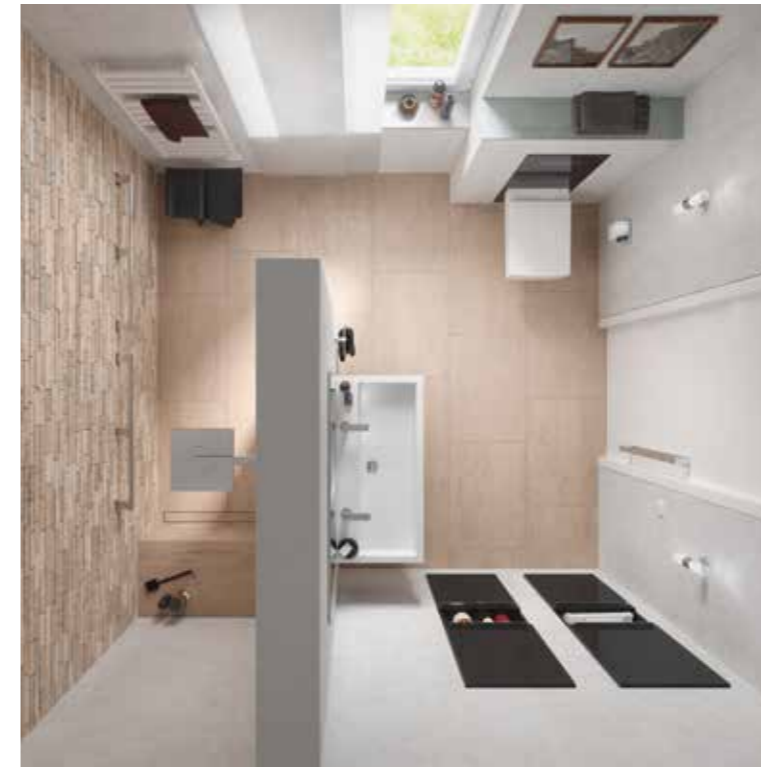

Convenience in all living situations

In renovation projects, city apartments are increasingly being converted into more accessible spaces. Owners often have high expectations in terms of convenience and aesthetics – along with the corresponding budget.

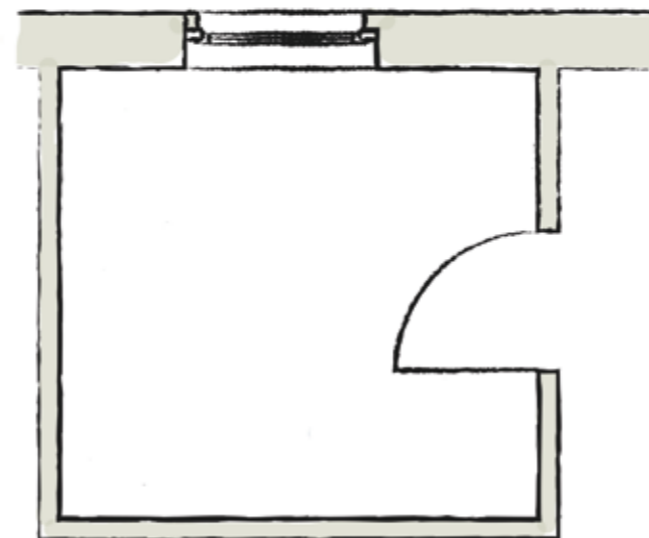

Efficiency in terms of function and budget

When living away from home – whether for students or modern business nomads – every last square metre must be put to good use. With this in mind, the bathroom must also be well-thought-out without putting a strain on the budget.

AN EXCELLENT LAYOUT WITH AN EXCELLENT DESIGN.

TECE products distinguish themselves through their clear contours and timeless design. Geometric shapes characterise the layout, while the focus remains on function. A variety of surfaces offer a wide range of means of expression.

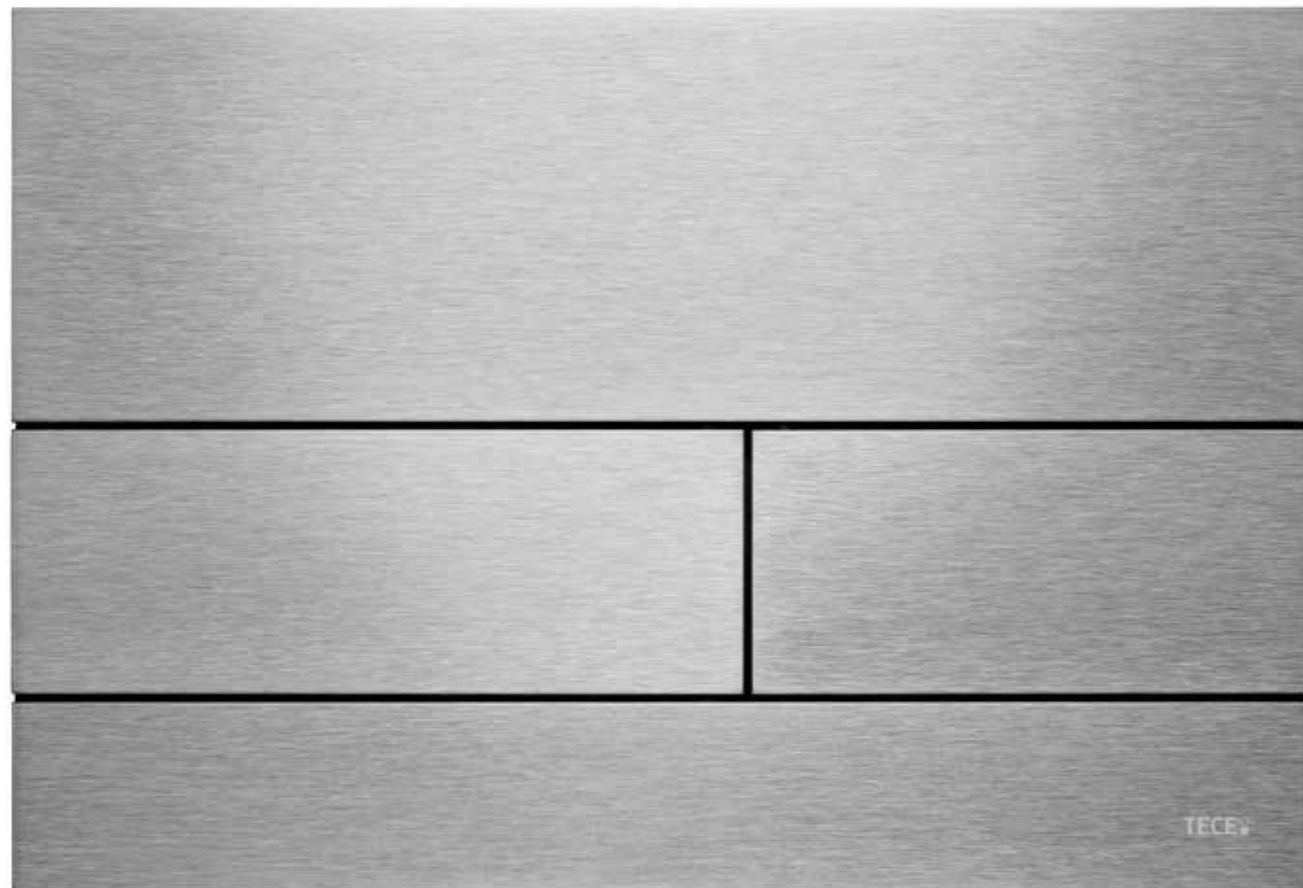

1

- 1 TECEsquare flush plate: The brushed stainless steel version is also protected by an anti-fingerprint coating.
- 2 TECElux Mini flush plate
- 3 TECEloop flush plate
- 4 TECEnow flush plate

Millimetre precision

The plate which is only two millimetres thick, the precise spacing and the lack of a surrounding frame give the TECEsquare flush plate its minimalist appearance. In addition to brushed stainless steel, other materials and surfaces are also available in wall-mounted or flush-mounted versions.

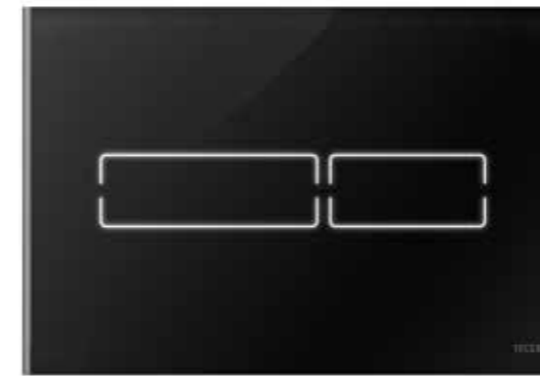

Light from glass

The TECElux Mini flush plate fulfils the highest demands for aesthetics, function and hygiene. The surface consists of safety glass and is available in white and black versions. The flush button is indicated by a continuous night light which can also be activated touch-free by means of a sensor.

2

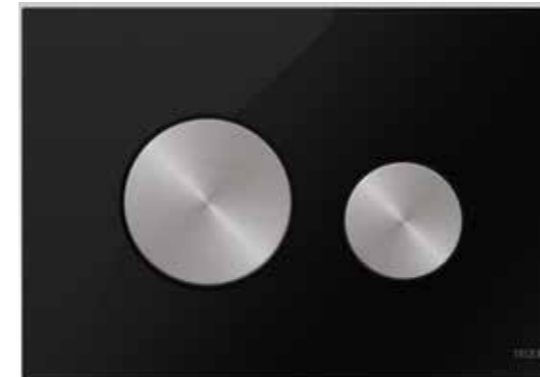

Circles in squares

The TECEloop flush plates offer hundreds of possibilities for a completely customised bathroom design. Buttons and plates can be individually designed and combined with many materials, colours and surfaces.

3

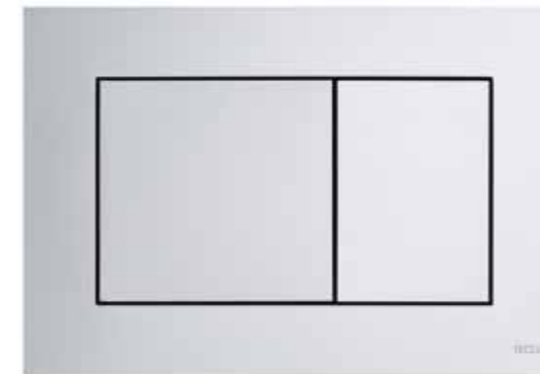

Timeless design in every case

The TECEnow flush plate with dual-flush technology is highly convincing with its minimalist design. This model has also been tried and tested in price-sensitive projects and in public areas – and is available as a toilet or urinal version.

4

Aesthetics plus

All TECE toilet flush plates can be flush-mounted to the wall as an option.

Awards

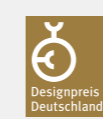

INNOVATIONSPREIS
ARCHITEKTUR +
TECHNIK

DESIGN PLUS

ON-TREND, WHILE PLANNING SAFELY.

TECE is up there with the latest trends. Structured collections are easily accessible and provide safety during guaranteed run times for architects and planners.

Shower channels: quite beautiful, simply practical

And best of all – available in the form of a functionally- and creatively-harmonised collection. TECE shower channels have a technically-modular design which enables safe and efficient planning.

Even if tastes change over the years, the technology remains the same. TECE shower channels are designed to offer maximum individuality and convenience in terms of their materials, shape and colours.

Just a few components – hundreds of possibilities

A TECEdrainline shower channel has a modular design and always comprises:

- a design grate, a tileable channel or a glass cover,
- a channel,
- a drain.



1



2



3

Designs with glass

A well-thought-out and harmonious bathroom layout is expressed in every detail. TECE creates its designer products in the form of a collection – for example, the glass collection. Glass is a highly aesthetic and, at the same time, low-maintenance material. The TECE collection includes shower channels, flush plates and floor room thermostats – for attractive, individual applications or for a harmonious overall design.

- 1 TECEdrainline shower channels
- 2 TECEfloor room thermostat
- 3 TECElux Mini flush plate



“steel” – available in brushed or polished stainless steel



“basic” – available in brushed or polished stainless steel, other designs in the range



White glass



Green glass



Black glass



Natural stone channel – can be matched to the individual floor cover



“plate” – can be tiled and matched to the individual floor cover

HOTEL INSPIRATION.

Designing bathrooms for hotels is a particularly dynamic field. New concepts are always being tried out in this area, offering international guests a high level of attractiveness. However, attention must also be paid to efficiency.

For both aspects, TECE offers the right products.



Mr. Galal Mahmoud – President of GM Architects

Hotel design trends

In the field of hotel design, it is no longer just about designing rooms. It is now much more a case of creating a holistic experience from check-in to the bedroom and from the bathroom to the dining area. It is no longer enough for a hotel to be labelled “Business” or “Leisure”. Today, people want to escape from their routine and try out new things. And they now pay greater attention to well-being. Indeed, the interest in wellness and convenience is steadily increasing.

The result: Hotel rooms are now also required to emanate a greater sense of relaxation and cosiness, and to appear less business-like and uniform. New forms of wellness are becoming increasingly important. The hotel room is a comfort zone where function, intelligence and design are combined. A real place of retreat.

The living area is merging more and more with the bathroom, which makes the room appear more generous, while at the same time allowing greater privacy.

This creates new challenges for architects and planners, regardless of the category in which a property is located. The optimum solution for this can only be an integrative product system. All elements of the visible and non-visible layout are perfectly harmonised in terms of technology and functionality. This means that products from third party manufacturers can also be integrated via open interfaces without any problem.

This is precisely the task fulfilled by TECE product systems, which, at the same time, facilitate design and implementation.

Aesthetics is the new standard

In the hotel business, “standard” no longer means cutting back on aesthetics. Exciting designer bathrooms which are attractive for guests can even be found in basic hotel categories. And this guarantees capacity and turnover.



High demands

Modern luxury is distinguished by originality and special materials. The wide range of shapes, colours and surfaces available enables creative design. Alternative solutions, such as contact-free toilet flushing and walk-in showers, offer the highest level of convenience.

- 1 Example: 3-star hotel bathroom – IBIS Style Hotel, Trier (source: Gilbert & Baasch group of companies, Trier)
- 2 Example: 5-star hotel bathroom – Sofitel Hotel “Tamuda Bay Beach and Spa”, Morocco

FREEDOM IN DESIGN

FUNCTION & INNOVATION

Safety in the system.



INNOVATION MEANS UNDERSTANDING.

The term “innovation” covers a wide spectrum of new developments which can range from platform technologies to playful subtleties. Whether or not such innovations also represent actual improvements is worked out in practice. TECE’s aspiration and incentive has always been to develop products and services that make sense and remain valuable in the long term through an accurate knowledge of customer requirements.



Less is more

The greatest skill of design lies in the art of reduction. TECE’s flush plates take this assertion on board. If desired, a special frame enables flush-mounted installation to the wall. For an unrestrictedly elegant and simple integration into any bathroom design.

Thinking out of the box

Toilets with a shower function have been a familiar sight in Asia for a long time. However, they are now also set to slowly conquer other cultures.

Up until now, they have been characterised by complex technology and an exuberant design, however, TECE is taking a different approach. TECEone does not require electricity or unnecessary gimmicks, which makes it suitable for a wide range of use. Timeless design included.



All inclusive toilet convenience

The TECElux toilet terminal offers the perfect combination of timeless design and sophisticated technology. The highlight: the latest technology is concealed in the pre-wall’s inspection opening behind the glass plate.

The result: contact-free flush actuation, a night light, odour trap, insert chute for cleaning tablets and smooth height adjustment.



- 1 TECEone toilet with shower function
- 2 TECEloop flush plate
- 3 TECElux toilet terminal

ON THE SAFE SIDE.

TECE products meet the highest technical and quality requirements. They can be universally combined within the same range and are compatible with other products from the sanitary sector. This means perfect scalability and safe planning from the home to series housing construction.

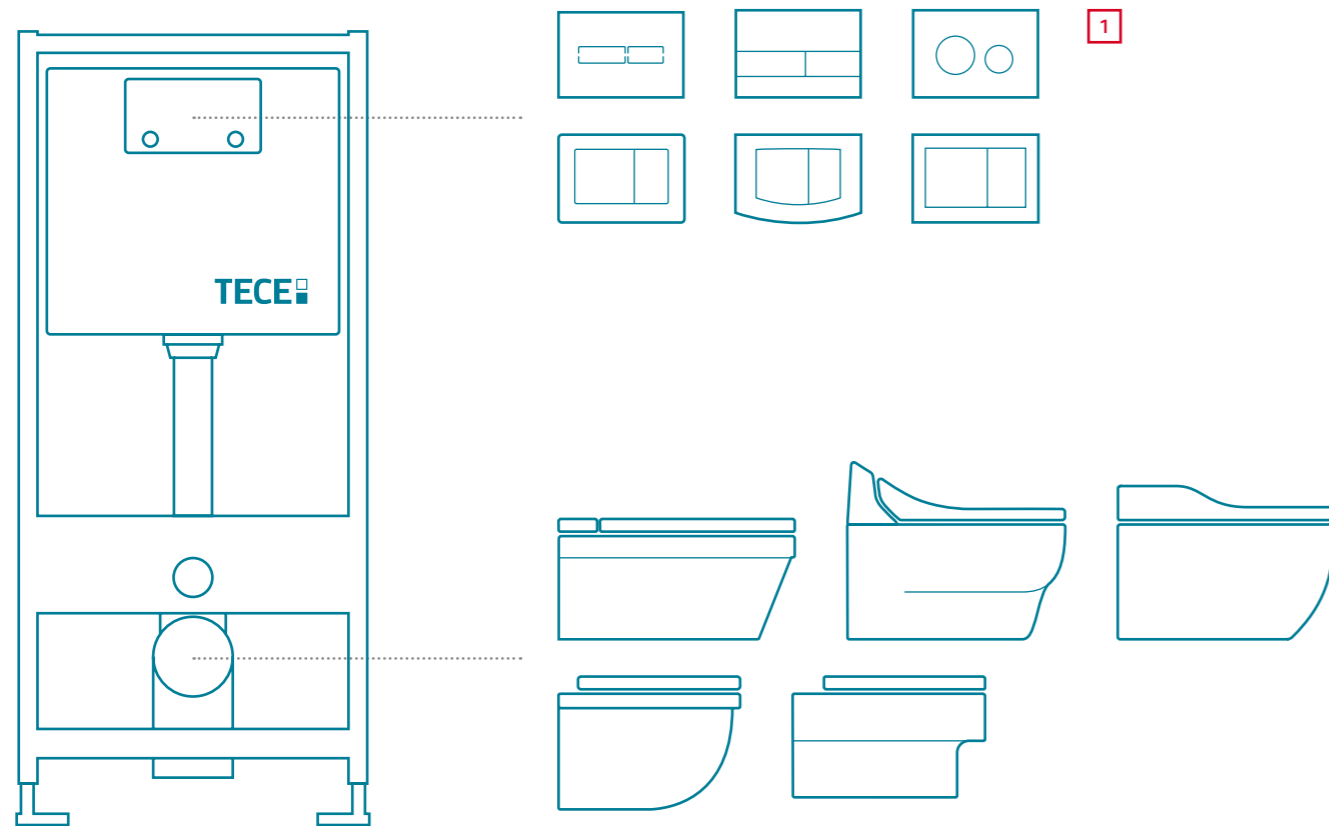

Safety in the system

Because needs are changing in the private environment, bathroom designs are also frequently changing. TECE products take these changes in their stride: technology installed “in the wall” is guaranteed to be compatible with the toilet ceramics and flush plates “in front of the wall”.

- 1 All flush plates fit on all cisterns, all toilet ceramics fit on all modules. The TECE's modular design enables safe and easy planning and implementation.
- 2 Hardness testing in continuous operation. Demonstrated here, TECE's own test bench for flush plates and cisterns.



2

Safety in the product

Whether for private, public or commercial use, TECE products comply with the complete range of legally required approvals at an international level. Each product undergoes strict tests, from raw materials purchasing to the final disposal site. Only in this way can long-term operation and durability be guaranteed for every area of use.

Pushed to the limits

TECE operates a range of automated test benches for fatigue and hardness tests. These are used not only to determine the required standard values but also to establish the actual application limits of products and systems.

Recognised on an international scale

TECE products and systems are subjected to continuous in-house and external quality and standardisation tests. Independent testing bodies confirm compliance with international provisions by issuing approvals and certificates.

Signs of quality

International products require international approvals. For that reason, TECE's pipe systems are continuously monitored by a whole range of international external inspection bodies.



FREEDOM IN DESIGN

SERVICES & ACADEMY

Run by professionals for professionals.



IN CONSTRUCTIVE DIALOGUE.

It is only by exchanging ideas that things can be improved. That is why TECE engages in intensive dialogue with partners and customers.



1

Thinking together

TECE includes architects and planners as early on as the product development design phase. Initial prototypes are discussed together and tested in interactive workshops. The aim: to make things better together.

More in-depth information is offered by the TECE Academy.



2

Samples for working creatively

The Sample Service shows how materials, colours, haptics and functions actually work together. On request, TECE sample swatches, sample items and information can be obtained directly.

Optimum advice

An expert will be happy to help with any queries – whether you require details about products, or personal property consulting in the architectural office or directly at the building site. To arrange a quick appointment, send a brief email or call us.

Planning more simply

Digital planning aids are available for efficient planning. They can be used to easily and quickly assemble suitable products for a project, and to calculate exact requirements.

- 1 TECE offers an extensive range of training courses, seminars and workshops.
- 2 See for yourself: sample materials and products are available e.g. for TECE flush plates.

GET TO KNOW US BETTER.

TECE provides expertise in further areas of competence. Visit www.tece.com where you can find detailed information about the company, products and services.

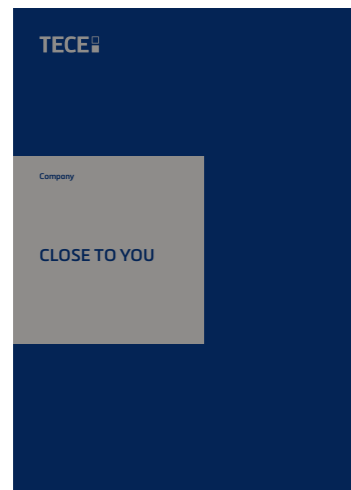

Company

Close to you – The corporate brochure emphasizes TECE's innovative culture and describes the family company's philosophy.



Project & Planning

Safety in terms of time, legal aspects and cost-efficiency. This brochure is intended for planners, architects and investors.



Installation & Assembly

Straight-forward, stress-free work. In this brochure, professional tradesmen can find out more about well-thought-out products, quality, services and the TECE Academy.

For more information, go to
www.tece.com

TECE GmbH
International Business
Phone +49 25 72 / 9 28 99 9
international-business@tece.de
www.tece.com